

 **Müller**  
AUSTRIA

# SONIC ULTRA 5

FIVE  
TOOTHBRUSH  
FUNCTIONS

*Whiten*

*Clean*

*Polish*

*Gum*

*Cycle*

**USER  
MANUAL**



## PARTS



Brush head, 2x



Brush attachment point

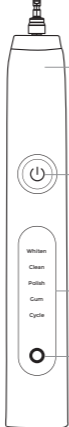

Hand piece

Multifunction button

LED mode indicator

Charge level indicator

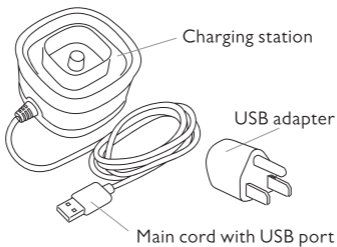

## IMPORTANT SAFEGUARDS

Mueller Sonic Ultra 5 has been carefully designed to offer you and your family a new and unique brushing experience that is both safe and effective. However, when using electrical products, basic safety precautions should always be followed.

***Before using the toothbrush, please read through the operating instructions carefully.***

1. Discontinue using this product if it appears to be damaged in any way (brush head or handle). Other than replaceable items, this product is not serviceable.
2. Avoid using a brush head with crushed or bent bristles. Damaged bristles may break off while brushing. Replace the brush head with a new one every 3 months or sooner if signs of wear appear. Inappropriate cleaning may cause bristle damage.
3. This product is designed for cleaning teeth, gums, and tongue only. Use this product only for its intended use as described in this booklet. Discontinue using this product and contact a physician/dentist if discomfort or pain is experienced.
4. This appliance is not intended for use by persons (including children) with reduced physical, sensory or mental capabilities, or lack of experience and knowledge, unless they have been given supervision or instruction concerning use of the appliance by a person responsible for their safety.
5. Children should be supervised to ensure that they do not play with the appliance.
6. This product is a personal care device and is not intended for use on multiple patients in a dental office or institution.
7. Do not use attachments other than those recommended by the manufacturer.
8. If your toothpaste contains peroxide, baking soda, or other bicarbonate (common in whitening toothpaste), it is important that you thoroughly clean your brush head and handle with soap and water after each use.
9. Consult your dental professional before you use this product if you have had oral or gum surgery in the previous 2 months.
10. Contact your dental professional if excessive bleeding occurs after using this product or bleeding continues to occur after 1 week of use.
11. Address questions concerning usage with a pacemaker or other implanted device to your physician or the implant device manufacturer.
12. Sonic Ultra 5 has been tested and is compliant with safety standards for electromagnetic devices.

13. Consult your physician prior to using the Mueller Sonic Ultra 5 if you have medical concerns.

14. To avoid damage due to battery leakage:

Do not expose the appliance to high temperatures such as direct sunlight or heating elements.

15. Do not leave empty batteries in the appliance.

## SAFETY

Only use the toothbrush as described in these operating instructions. Any other use is deemed improper and may result in damage to property or even personal injury. The toothbrush is not a children's toy. Mueller accepts no liability for damage caused by improper or incorrect use.

## DANGER

To reduce the risk of electrocution:

1. Do not place or store the charger where it can fall or be pulled into a tub or sink.
2. Do not place the charger in water or other liquid.
3. Do not reach for a charger that has fallen into the water. Unplug immediately.

## WARNING

To reduce the risk of burns, electrocution, fire or injury:

1. Close supervision is necessary when this product is used by or near children or invalids.
2. Use this product only for its intended use as described in this manual. Do not use attachments not recommended by the manufacturer.
3. Keep cord away from heated surfaces.
4. Never drop the appliance or insert any object into any opening of the appliance.
5. Never operate this product if it has been dropped or damaged, if it is not working properly, or if Charging station, Main port with USB port or USB adapter is damaged or has been dropped into water. If any of these occur, please contact a service center and return the product for examination and repair.
6. This appliance is provided with a Charging station with USB adapter with integrated Safety Extra Low Voltage power supply. Do not exchange or manipulate any part of it.



2 Brush  
Heads



2 Minute  
Auto-Timer



New  
Technology



Multifunctional  
Button



LED  
Indicator



Charge Level  
Indicator

## INTRODUCING YOUR SONIC ULTRA 5

Up to 10 times more plaque removal\*

For white teeth and less staining

Up to 7 times healthier gums\*

Up to 100% less stains in just 3 days\*

We use sonic technology to sweep away plaque and give a deeper clean.

No other brush on the market can compete with our up to 66,000 brush movements per minute.

## OPERATION

Charging the rechargeable battery

1. Insert the main cord with USB port into the included USB adapter.
2. Place the toothbrush on the charging station. The toothbrush will now be inductively charged.
3. The charge level indicator is illuminated in red during the charging process.
4. The toothbrush is fully charged after approx. 16 hours and the charge level indicator goes out. Once fully charged, the rechargeable battery will keep for up to 3 weeks.

## USING THE TOOTHBRUSH

- Do not apply too much pressure to the toothbrush and your teeth when brushing them.
- Your gums may bleed the first few times you use the toothbrush. If your gums bleed for more than 14 days, please consult a dentist.
- Brush your teeth using small circular movements.
- Clean up to the spaces between your teeth.

## BRUSHING YOUR TEETH

1. Attach the brush head to the hand piece so that the brush attachment point in of the hand piece extends into the brush head.

2. Select the desired mode by pushing the multifunction button within 3 seconds (see chapter "Selecting the mode"). Wait for more than 3 seconds to switch the toothbrush off.

3. Brush the upper and lower parts of your teeth as well as the exterior and interior of your teeth for 30 seconds each without applying pressure.

 After every 30 seconds interval, the toothbrush will stop for 0.5 seconds and automatically switch off after 2 minutes.

4. After each use, clean the toothbrush as described in the chapter "Cleaning".

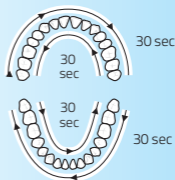
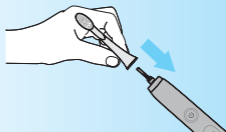

## SELECTING THE MODE

The LED mode indicator displays the current mode.

Function	Operation	Description
Whiten	Push 1×	For white teeth and less staining.
Clean	Push 2×	For removing plaque, perfect for sensitive teeth and gums.
Polish	Push 3×	For polishing teeth.
Gum	Push 4×	For gently massaging your gums and improving the health of your gums.
Cycle	Push 5×	For getting used to the tooth-brush. The vibration intensity gradually increases from weak to strong during the first 12 applications.

## CLEANING

1. After every use, hold the brush head under running water and switch the toothbrush on.
2. Remove all leftover toothpaste from the brush head and the hand piece and switch the toothbrush back off.
3. Pull the brush head off of the hand piece.
4. Also, clean the brush head by holding it under running water.
5. Dry the brush head and the hand piece before you reassemble the brush and put the handle on the charging unit.
6. It is recommended to change the brush head every 3 months of frequent use.



As soon as the color of the brush head fades, change it. You can purchase new brush heads on our website.

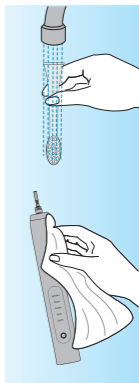

## TROUBLESHOOTING

Problem	Possible cause	Solution
The toothbrush isn't charging.	The charging station is defective.	Try other sockets or USB connector jacks and charge the toothbrush for at least 16 hours.
	The USB connector jack is defective.	Try other sockets or USB connector jacks and charge the toothbrush for at least 16 hours.
	The charging station is defective.	Replace the charging station within the warranty period.
The toothbrush operates with only a small amount of vibration.	The rechargeable battery is depleted.	Charge the toothbrush for at least 16 hours.
The toothbrush does not run for 2 minutes.	The rechargeable battery is depleted.	Charge the toothbrush for at least 16 hours and make sure that the toothbrush is properly placed on the charging station.

## TECHNICAL DATA

Model number: 5G-986  
Article number: SS I PEUW00 I

### Charging station

Mains voltage: 100-240 V—, 50/60 Hz  
Power consumption: 1.5 W  
Protection class: III  
IP code: IPX7  
Dimensions (L x W x H): 6.2 x 6.2 x 4.3 cm

### Hand piece

Rechargeable battery: 3.7 V, 700 mAh  
Operating time: 42 times/full charge  
Timer: 0.5 second pause after approx.  
30 seconds, deactivation after 2 minutes  
Dimensions (L x W x H): 2.6 x 2.7 x 25.4 cm

### Adapter

Model number: ZD5C050060EUDU  
Input: 100-240 V~, 50/60 Hz, 0.2A  
Output: 5.0V --- 600mA  
Protection class: II



### 3-Year Limited Warranty

This product is warranted to be free from defects in material and workmanship under normal use and service for 3 years from the date of original purchase with receipt. The manufacturer's obligation shall be limited to repairing or replacing, FOB, NY, any part of the product that is defective. Such warranty shall not apply to damages resulting from accidents, abuse or misuse. This warranty is valid only for First quality goods purchased from an authorized selling agent of IDL 10/10.



### Your purchase comes with a 100% satisfaction guarantee from Müller

*If you are not happy with the product for any reason, please contact us at [support@muellerdirect.com](mailto:support@muellerdirect.com) or at 1-888-632-9981 with your feedback or questions, and we will do our best to make things right for you!*

 **Müller**  
A U S T R I A

515 HARAM AVE, OPA LOCKA, FL 33054, USA

1-888-632-9981

[support@muellerdirect.com](mailto:support@muellerdirect.com)

[www.muellerdirect.com](http://www.muellerdirect.com)